



33 Twiss Meadow, Beverley, HU17 8YU
£245,000

The Property Perspective

Garden Place, Victoria Street, Altrincham, WA14 1ET

Tel: 08456 800 262 Fax: 08456 800 272

Email: enquiries@thepropertyperspective.co.uk www.thepropertyperspective.co.uk

PROPERTY
PERSPECTIVE

Property Perspective are delighted to be able to present to you this beautifully presented and maintained 3 bedroom semi-detached house, situated on the outskirts of Beverley. Benefiting from modern sophisticated decor throughout, en-suite shower room and landscaped rear garden.

The living accommodation briefly comprises of; lounge, open plan kitchen/diner, utility and WC/cloaks. To the first floor 3 bedrooms, en-suite shower room and modern bathroom.

The property is located within a sought-after catchment area for local schooling at both Primary and Secondary levels, with schools boasting a 'GOOD to OUTSTANDING' OFSTED ratings. The area is also ideally located for local amenities/shops and travel links.

FREEHOLD

Council tax band - C

GROUND FLOOR

Lounge 12'3" x 17'7" (3.74m x 5.36m)

Carpet flooring with bay fronted window and blind

Diner kitchen 12'3" x 17'7" (3.74m x 5.36m)

High quality vinyl flooring with patio doors leading to the rear garden, spotlighting and blind. A range of fitted kitchen units, worktops and integrated kitchen appliances, including double oven, hob, hood, dishwasher and fridge-freezer

Utility 4'3" x 7'2" (1.31m x 2.20m)

High quality vinyl flooring with plumbing for washing machine and blind

WC/cloaks

High quality vinyl flooring with 2 piece bathroom suite in white and radiator

FIRST FLOOR

Bedroom 12'4" x 11'6" (3.78m x 3.51m)

Carpet flooring with window to the front elevation, fitted wardrobes and blind

En-suite

High quality vinyl flooring with 2 piece bathroom suite in white, separate showering enclosure, spotlighting, heated towel rail and partially tiled decor

Bedroom 8'9" x 11'7" (2.67m x 3.55m)

Carpet flooring with window to the rear elevation, fitted wardrobes and blind

Bedroom 8'2" x 6'5" (2.50m x 1.97m)

Carpet flooring with window to the rear elevation and blind

Bathroom

High quality vinyl flooring with 3 piece bathroom suite in white, shower over bath with glass splash-back screen, spotlighting and partially tiled decor

EXTERNAL

Beautifully presented and private rear garden, enclosed by panel fencing with laid to lawn and patio area. Driveway to the side of the property, capable of accommodating 2 large vehicles.

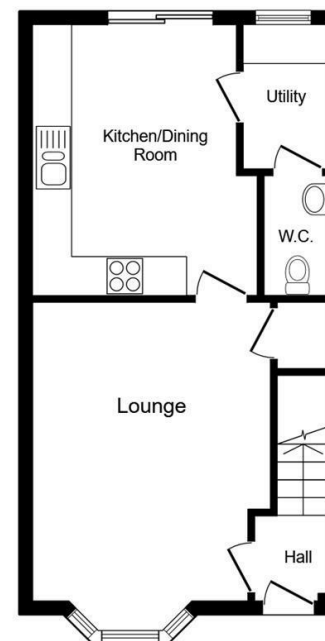

Ground Floor

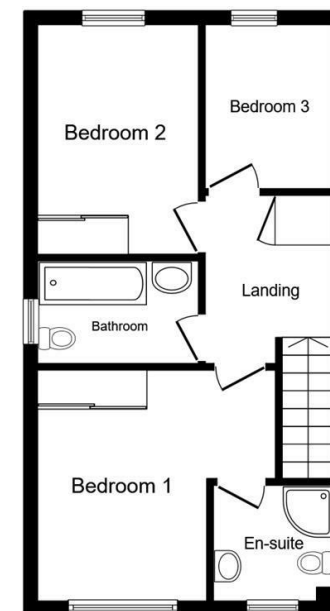

First Floor

This floor plan is for illustrative purposes only. It is not drawn to scale. Any measurements, floor areas (including any total floor area), openings and orientations are approximate. No details are guaranteed, they cannot be relied upon for any purpose and do not form any part of any agreement. No liability is taken for any error, omission or misstatement. A party must rely upon its own inspection(s). Powered by www.Propertybox.io

PROPERTY
PERSPECTIVE